



F TYPE Technical Specification

F connectors were designed as a low cost method of coupling coaxial cables and equipment used in TV, MTV, and satellite communication applications. They have threaded coupling interfaces and the plug utilizes the centre contacts of the cable rather than a separately applied pin. They are designed for low frequency transmissions (typically video) up to 2GHz.

ELECTRICAL

Impedance	
Plugs Without Contact	Non Constant (Impedance of Cable Applies)
Plugs With Contact	75 Ohms
Jacks	75 Ohms
Frequency Range	DC to 2GHz
Working Voltage (RMS)	250V
VSWR	
Cable Fixing	1.35:Max
Non Cable Fixing	Not Applicable

MECHANICAL

Mating Torque	3.4NM
Durability	
Plugs Without Contact	50 Cycles (Subject to Cable)
Plugs With Contacts	200 Cycles
Jacks	200 Cycles

MATERIALS

Body and Coupling Nut	Brass, Nickel Plated
Contact	Brass, Tin Plated
Ferrule	Brass, Nickel Plated
Insulator	Delrin, Polypropylene, PBT or PTFE
Nut	Brass, Nickel Plated
Washer	Brass, Nickel Plated



F Series

Crimp Attachment for Flexible Cable

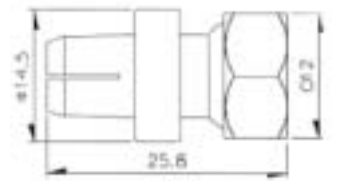
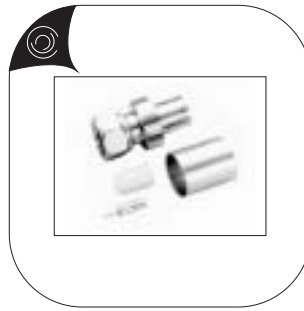
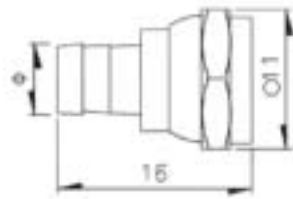
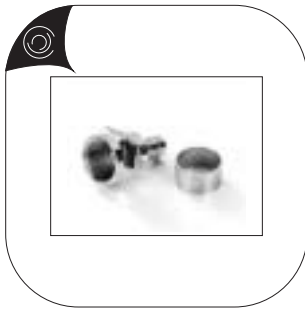

F101:F Straight Crimp Plug(3C, 4C, 5C, 7C) **F108:**F Straight Plug

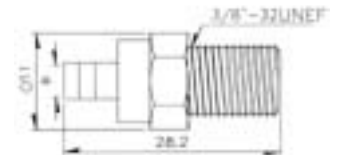
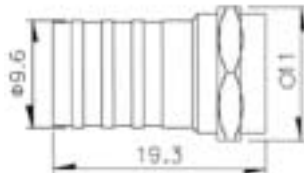

F105:F Straight Plug Attached Grip Ring (4C, 5C)

F210:F Bulkhead Crimp Jack

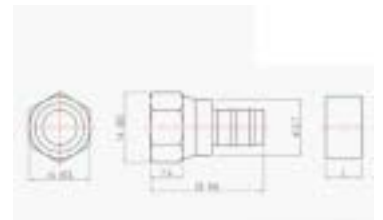
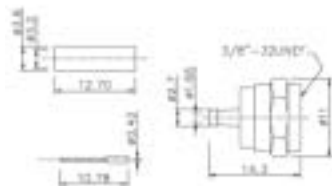
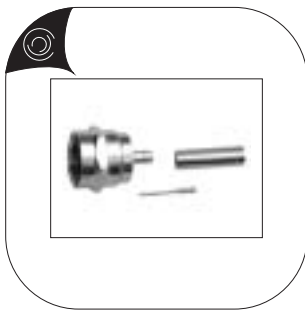

F112:F Straight Crimp Plug

F119:F Crimp Plug

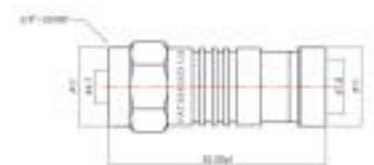
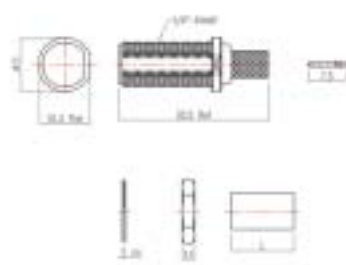

F211:F Straight Crimp Jack, Pin in Pin

F118:F Plug Waterproof Connector



F Series Twist-on Attachment for Flexible Cable



F102:F Twist-on Plug

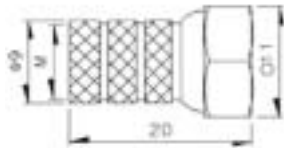

F107:F Twist-on Plug

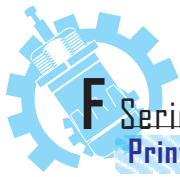
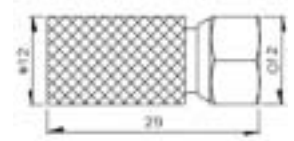

F Series Printed Circuit Board Terminal



F203:F Quick Jack(G Series)



F222:F Jack

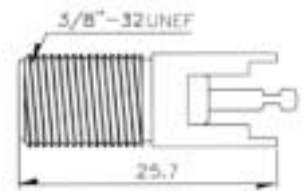

F221:F Jack

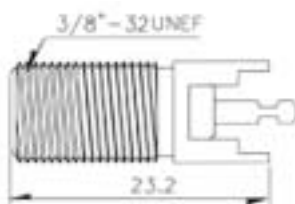

F223:F R/A Jack

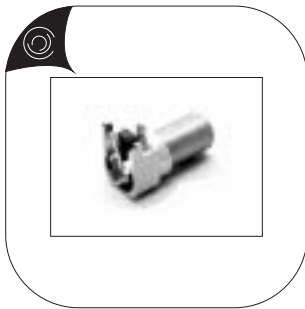
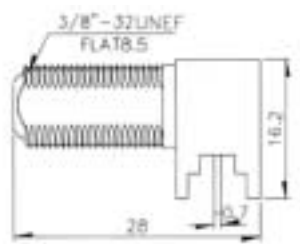

F224:F R/A Jack



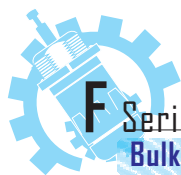

F Series Bulkhead Receptacle, Solder Pot Terminal

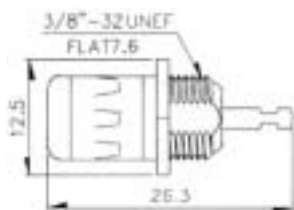

F202: F Bulkhead Quick Jack (G Series)

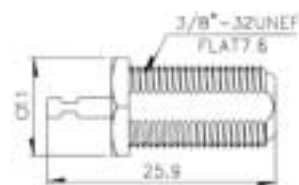
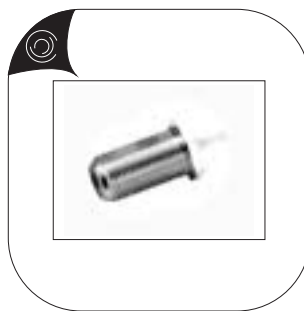

F206: F Bulkhead Jack

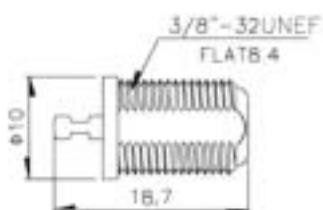
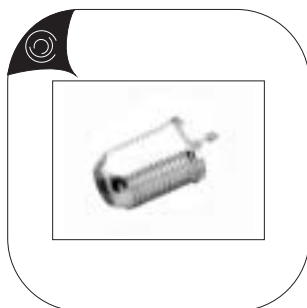

F207: F Bulkhead Jack

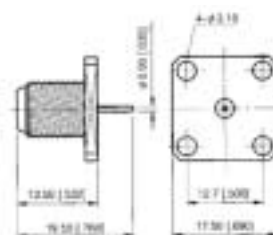
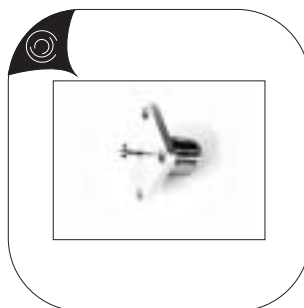

F209: Panel Mount Jack Receptacle-4-Hole Flange

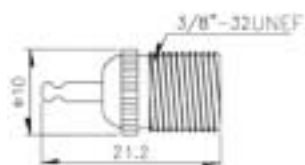

F212: F Bulkhead Jack

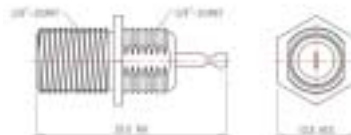

F208: F Bulkhead Jack

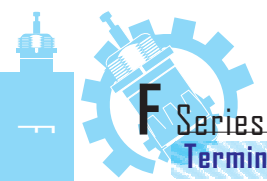

F Series Terminator & Cap

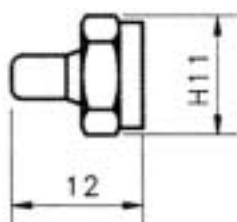
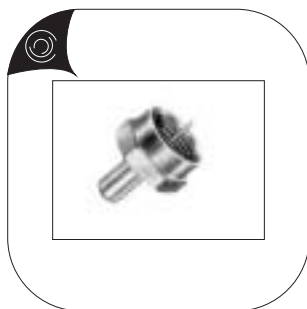

TE120: F Plug Terminator, 75R

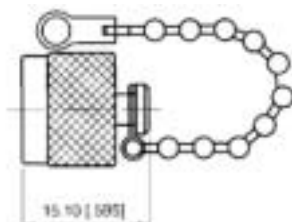

TE115: Dust Cap



TE121:F Plug Terminator

This image shows a full page of white paper with horizontal blue or grey ruling lines, typical of notebook paper. The lines are evenly spaced and run across the width of the page. There is no handwriting or other markings on the paper.